

PHILIPS

www.philips.com

HRC Product Portfolio Training

PHILIPS

Ventilators

Noninvasive

Invasive



Respironics V60

Mid Acuity

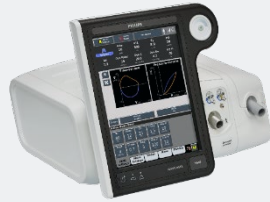

Respironics V680

Low Acuity



Trilogy 202

Consumables

Noninvasive Ventilation Masks and Circuits

AF541



PerforMax

AF531



AF421



AF811



AP111



Pediatric PerforMax



PN841



Hospital Respiratory Care Ventilator Family



V60

Non-Invasive Ventilation with
Superior Patient Comfort



V680

Non-Invasive Ventilation
with Life-Support
Capabilities



Trilogy 202

Non-Invasive
Ventilation with Life-
Support Capabilities,
Transport ready



V60

Dedicated
to Successful
NIV

- ICU grade NIV performance with enhanced monitoring and alarms
- Treatment for a wide range of clinical severities and patients from pediatric to adult
- Approved for use on patients 20kg and up
- Flexibility for intra-hospital transport with internal 6 hour battery
- Advanced NIV with Auto-Trak
- Connectivity



- AVAPS - maintains a target tidal volume in a pressure-limited mode.
- PCV - can be used when full control of the patient's breathing pattern is required.
- CPAP - Three levels of flow-based expiratory pressure relief.
- Proportional Pressure Ventilation (PPV) - provides inspiratory flow and pressure in proportion to the patient's spontaneous effort (*optional*)
- Auto-Trak Plus – A customized titration of triggering and cycling criteria (*optional*)



V680

The two-in-one ventilator

- Meets the changing therapeutic needs of a broad range of adult and pediatric patients
- Bridges the gap between dedicated NIV and critical care life support
- Single-limb non-invasive ventilation and dual-limb invasive ventilation
- Fast and easy switch from invasive to non-invasive ventilation
- Emergency Ventilation Mode



- Simple, familiar operation (based on V60)
- Auto-Trak+
- 4 hour built-in battery for intra-hospital transport
- Alarms and back-up ventilation
- Escalating alarms
- Apnea back-up ventilation mode
- Dynamic Respiratory Mechanics in NIV and IV
- Connectivity



GCX Cart for MX550 with V680

Cart includes:

- IV pole with 4 hooks
- Mounting system for power cable
- MX550 mount with tilt and swivel capabilities
- Custom tray with integrated handle and cable management features for V680 (V680 quick-connect feet to be provided by Philips)
- Downpost with humidifier mount
- Storage basket
- Single e-cylinder mount (dual cylinder optional)
- Counterweight for stability

Price: \$1500 each



Total height with IV post: 191 cm
Width: 50 cm
Depth including cylinder: 78 cm

What's new in v1.3

V680 Version 1.30 Software Features

1. Changing the primary mode breath type automatically changes the Apnea mode breath type to match.
2. The label on the Apnea controls button now reads "Apnea Settings".
3. Selecting Mask/Interface Leak "1" and Exhalation Port "None" prompts a message that the selection is not allowed.
4. When the User changes the Auto-Trak+ settings from Normal values, the Auto-Trak+ label displays on the Active Mode bar.
5. The user can now view any alarm condition that occurs while in any non-ventilating start up screen.
6. When configuring the ventilator for single limb ventilation, the user is able to see if a failed EST is in memory.
7. The Minute Volume Alarm will not trigger on start up until after delivering the number of breaths to compute the minute volume.
8. The Manual Breath button is always visible and active during ventilation, even when the alarms screen is open.
9. The 2-minute 100% O2 button is always visible and active during ventilation, even when the alarms screen is open.
10. Updated default settings for each patient type, mode and breath type.
11. Mode changes retain the common ventilator settings such as FIO2, PEEP, Pressure Support and Trigger Sensitivity.
12. The batch settings labels are a bolder yellow so the user can easily distinguish between altered and non-altered settings.
13. The touch sound volume is at a fixed level and not linked to the volume adjustment of the audible alarm.
14. The auto escalation feature is now abled/disabled in the diagnostic mode. The delay period to begin alarm volume escalation changes from 45 sec. to 15 sec. Alarm auto escalation status displays in the Menu tab under "Loudness".
15. Added Languages: Simplified Chinese, Japanese and Russian.
16. The user can now save and recall multiple loops to assess changes. Save up to five loops with time and date stamps.
17. Selecting a single-limb circuit in the Configuration Menu, yet using a dual-limb circuit, triggers an alert that an incorrect circuit is used.
18. The EST is now all inclusive of pre-use checks and includes the SST tests. Both EST and SST now require an oxygen connection due to the addition of a cross-calibration feature.
19. There is an expanded selection of approved filters and circuits on V680. Passing EST clears the tested circuit, filter and accessory combination.
20. Flow-Trak demand flow is now available to the patient during volume ventilation.
21. In PRVC, the Min P and Max P settings are now relative to the PEEP level.
22. The 10 mm circuit is no longer a circuit selection.
23. There are no patient weight ranges on the Adult and Pediatric patient selection buttons.
24. The Philips Ventilator Open Interface (PVOI) is a new connectivity protocol.
25. In the Configuration Screen, there is a new button labeled "Yes" to confirm that there are filters installed.

Screen changes

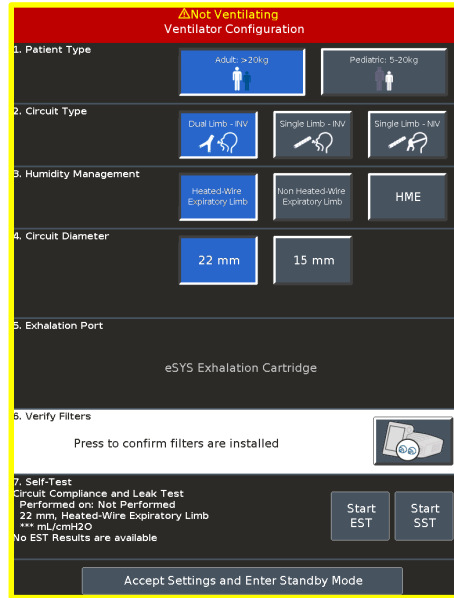

Red Software (Version 1.2)

See and silence alarms in Configuration Screen

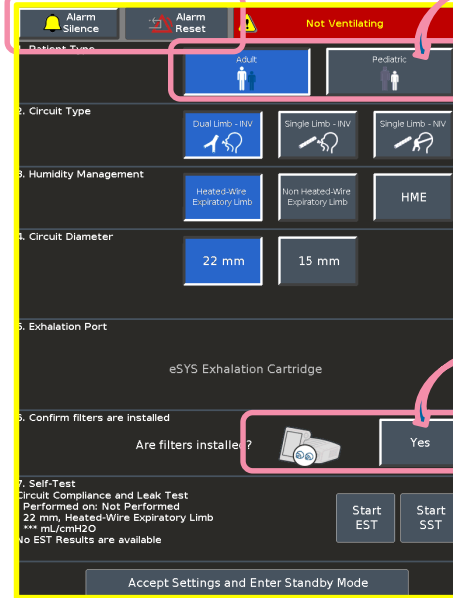

New Software (Version 1.3)

Weight labels removed

Touch to confirm filters

Changes to EST and SST

EST

⚠ Not Ventilating
Dual Limb EST

1. Patient Disconnect Test	<input type="checkbox"/>
2. Sensor and System Test	<input type="checkbox"/>
3. Circuit Compliance and Leak Test	<input type="checkbox"/>
4. Alarm Speaker and LED Test	<input type="checkbox"/>
5. Exhalation Valve Calibration	<input type="checkbox"/>
6. Oxygen Sensor Calibration	<input type="checkbox"/>
7. Remote Alarm Test	<input type="checkbox"/>

Patient Disconnect Test

Assemble patient circuit exactly as it is intended to be used, including: water trap, filter(s), heated humidifier or HME. Then connect to the ventilator.

Verify O₂ is connected.
Verify the patient is disconnected before proceeding, then press 'Start Test'.

Start Test

- You no longer have to run the SST and then EST between patients.
- Only run the EST.
- Use SST for circuit changes only.

SST

⚠ Not Ventilating
Dual Limb SST

1. Patient Disconnect Test	<input type="checkbox"/>
2. Circuit Compliance and Leak Test	<input type="checkbox"/>
3. Remote Alarm Test	<input type="checkbox"/>

Patient Disconnect Test

Assemble patient circuit exactly as it is intended to be used, including: water trap, filter(s), heated humidifier or HME. Then connect to the ventilator.

Verify the patient is disconnected before proceeding, then press 'Start Test'.

Start Test

- SST will pass a wider range of circuits and filters.
- Always run SST with all filters, humidifiers and adapters



New cross-calibration feature requires O₂ connection for EST and SST.



Screen changes (New start up settings)

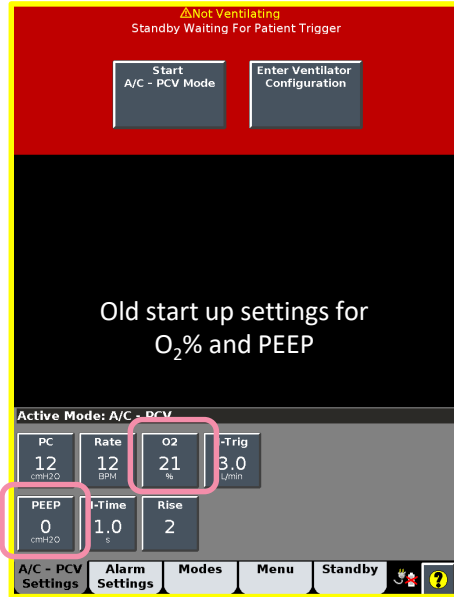

Old Software (Version 1.2)

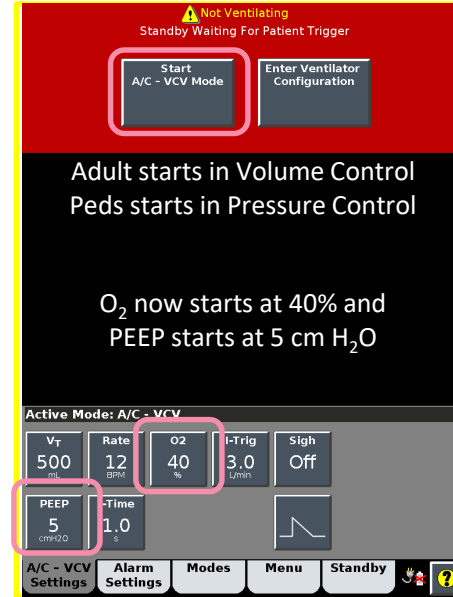

New Software (Version 1.3)

Screen changes (Apnea settings simpler)

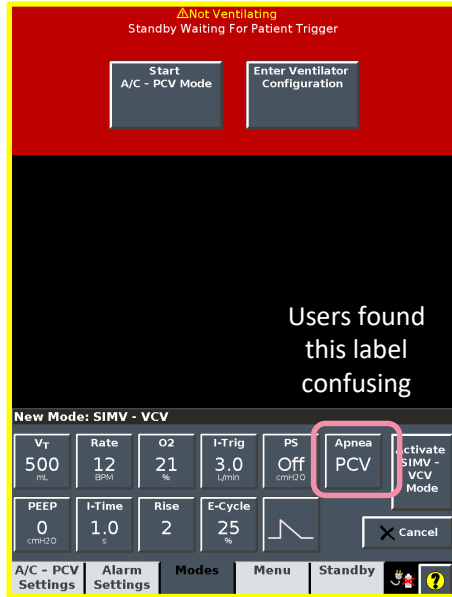

Old Software (Version 1.2)

Apnea settings default to the current breath type VCV or PCV

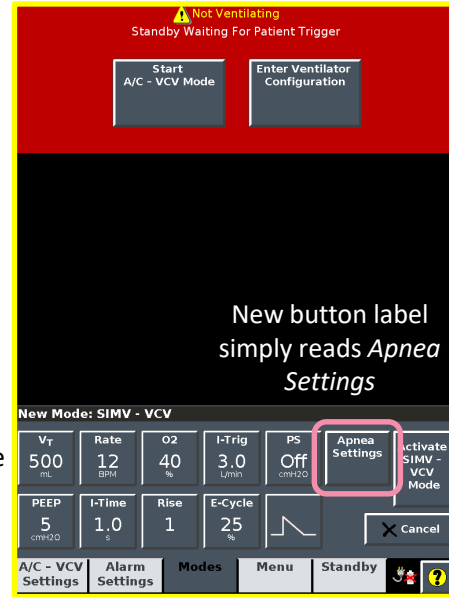

New Software (Version 1.3)

Screen changes (100% O2 Button always displayed)

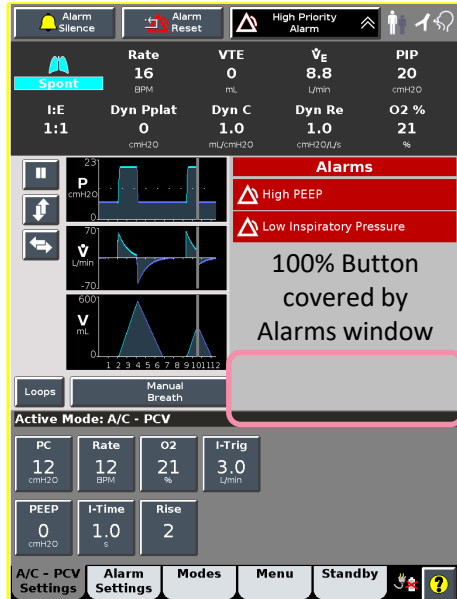

Old Software (Version 1.2)

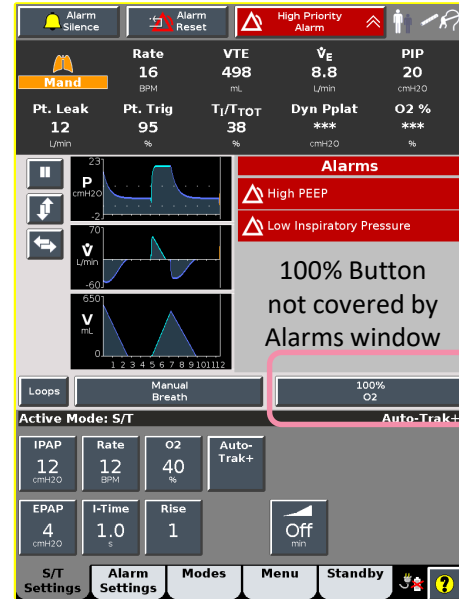

New Software (Version 1.3)

Screen changes (Loop save and overlay)

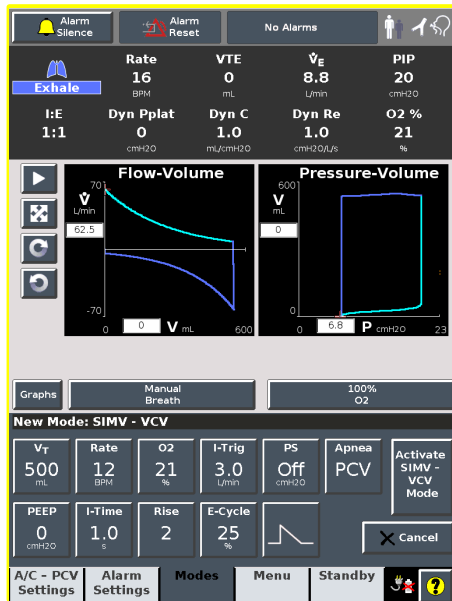

Old Software (Version 1.2)

New controls for saving and deleting loop overlays

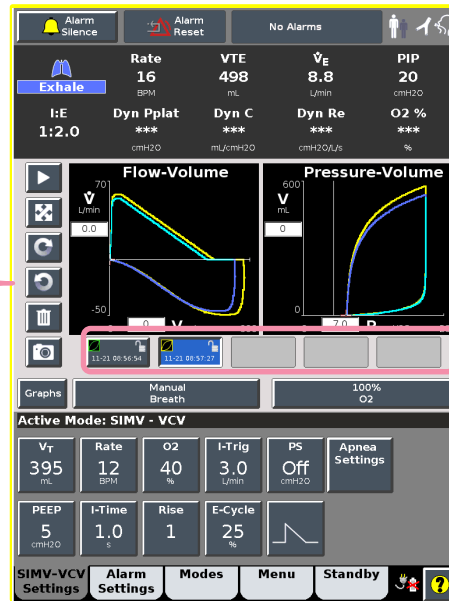

New Software (Version 1.3)

Save up to 5 loops with date and time stamps for trending. Button Color matches loop color for easy identification.

Other screen changes (Common settings retained)

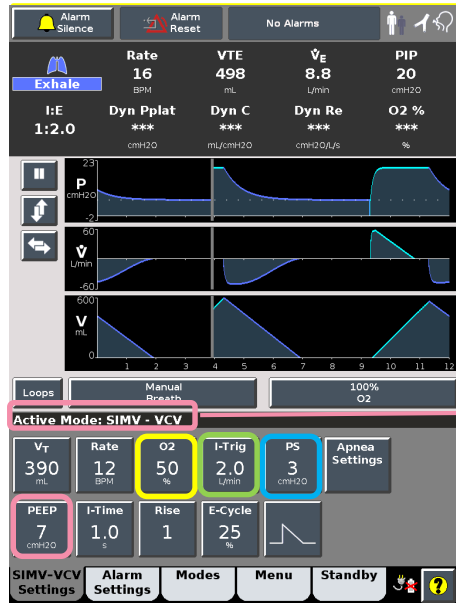

New Software (Version 1.3)

Common settings are retained when you change to a new mode.

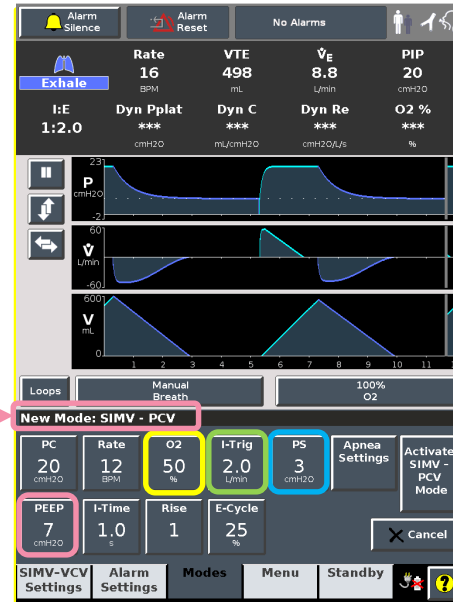

New Software (Version 1.3)

Other screen changes (Escalating alarm volume)

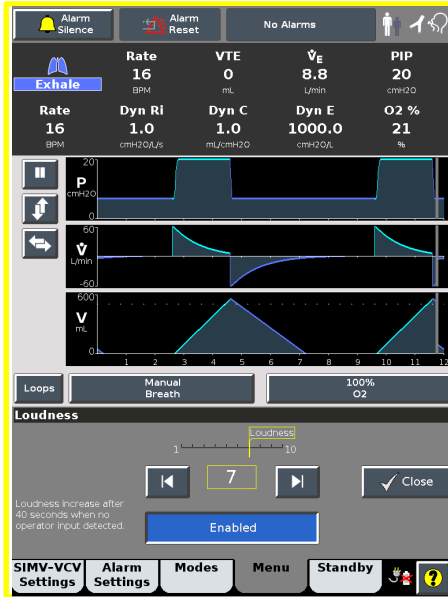

Old Software (Version 1.2)

Enabled and disabled in Loudness Menu tab.

Time delay was 40 seconds.

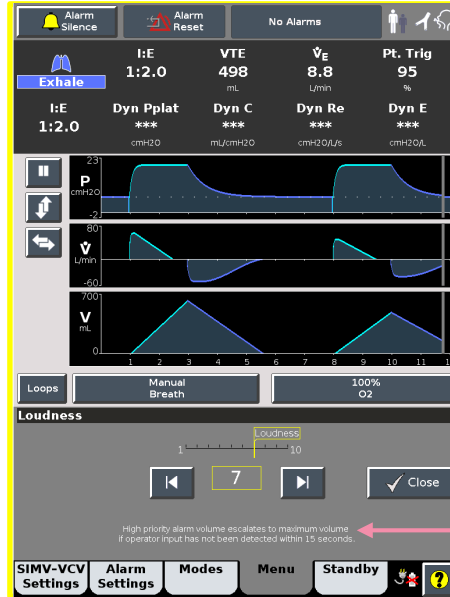

New Software (Version 1.3)

Enabled and disabled in Diagnostic Screen System Settings.

User informed time delay is now 15 seconds.

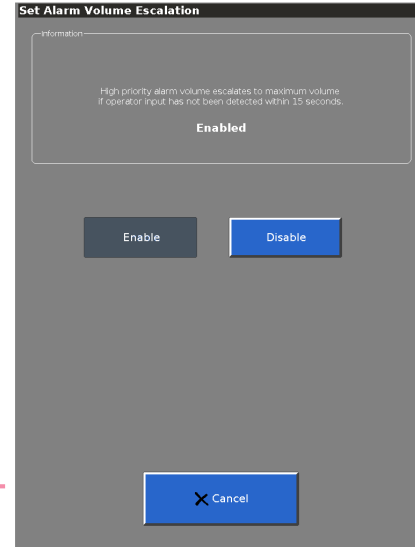

New Software (Version 1.3)

Enabled and disabled in Diagnostic Screen System Settings.

Other screen changes

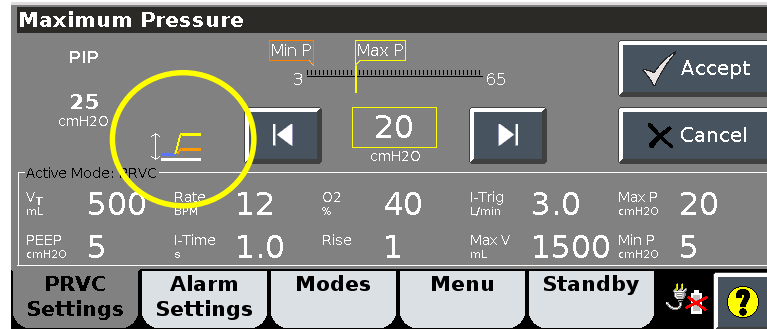
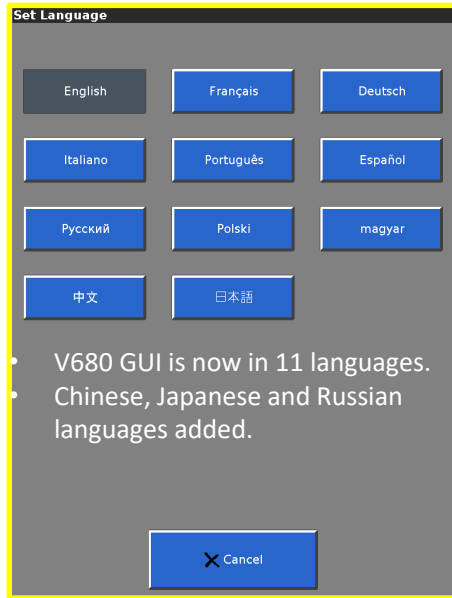

PRVC MaxP and MinP are relative to PEEP now.
Previously, they were absolute.

Other screen changes (small, but significant)

Batch settings colors are more visible

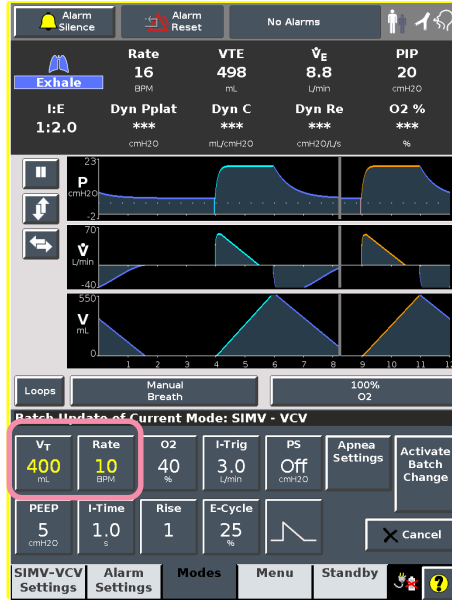

New Software (Version 1.3)

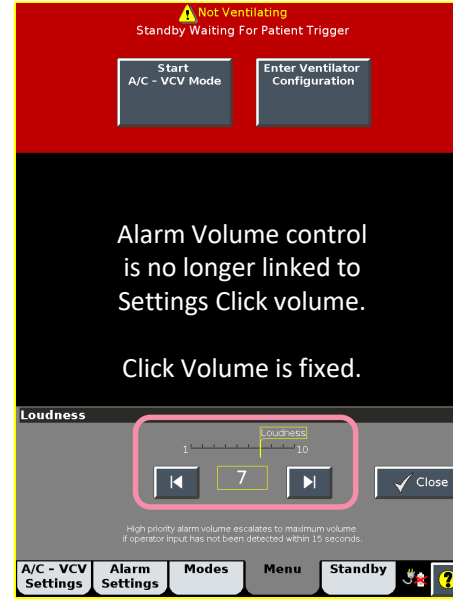

New Software (Version 1.3)

Other screen changes (Single limb set up)

1. Patient Type: Adult (selected), Pediatric

2. Circuit Type: Dual Limb - RV, Single Limb - RV, Single Limb - NV (selected)

3. Humidity Management: Heated, None

4. Mask/Patient Interface: Check Responics Mask for Leak Symbol and Value. Buttons: $P:1$, $P:2$, $P:3$, $P:4$, Other. Selected: $P:1$

5. Exhalation Port: Responics Disposable Exhalation Port (DEP), Whisper Swivel, Port. Selected: DEP

6. Confirm filter is installed: Filter Installed

7. Self-Test: Passive Exhalation Port Test Performed on: Test Not Required. Start SST

No EST Results are available

Accept Settings and Enter Standby Mode

EST status now displayed to show why you cannot advance out of configuration screen

New Software (Version 1.3)

Alarm Silence, Alarm Reset, No Alarms

Rate: 16 BPM, VTE: 498 mL, \dot{V}_E : 8.8 L/min, PIP: 20 cmH₂O

Pt. Leak: 12 L/min, Pt. Trig: 95 %, T_i/T_{TOT}: 38 %, Dyn Pplat: *** cmH₂O, O₂ %: ***

Waveforms: P (cmH₂O), V (L/min), V (mL)

Loops: Manual Breath, 100% O₂

Active Mode: S/T, Auto-Trak+

IPAP: 12 cmH₂O, Rate: 12 BPM, O₂: 40 %, Auto-Trak+

EPAP: 4 cmH₂O, I-Time: 1.0 s, Rise: 1

S/T Settings, Alarm Settings, Modes, Menu, Standby

If Auto-Trak+ settings are changed, label is displayed on mode status bar

New Software (Version 1.3)

Other screen changes (Single limb set up)

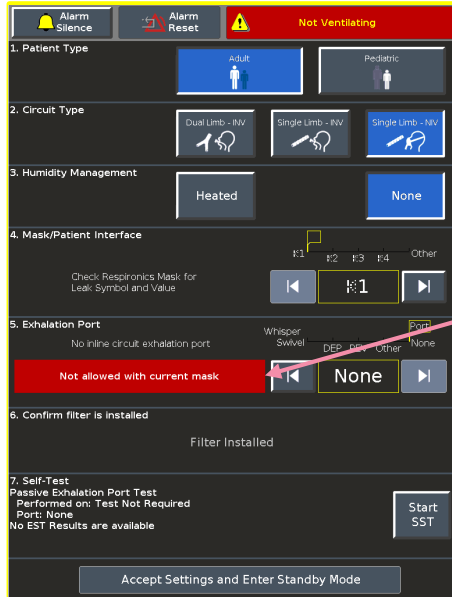

New Software (Version 1.3)

If mask and port selection is not allowed, message will alert user. Before, user could not advance to next screen, but was not clear why.

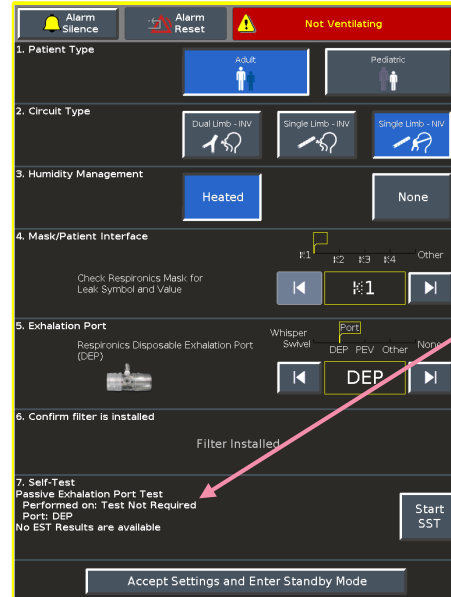

New Software (Version 1.3)

If Leak 1 and DEP are selected, no port test is required. SST button is available for Remote Alarm Test only.

Other screen changes (Single limb set up)

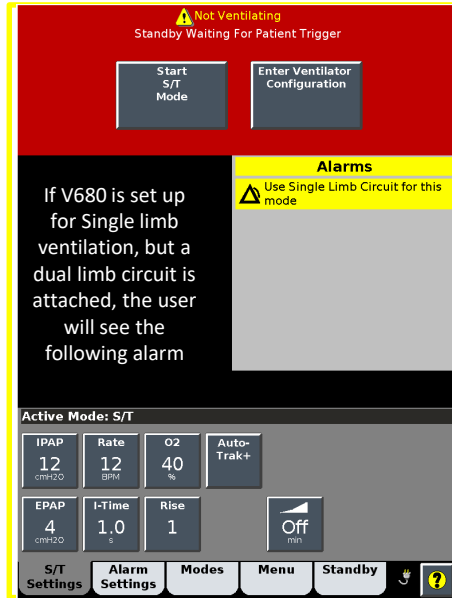

New Software (Version 1.3)

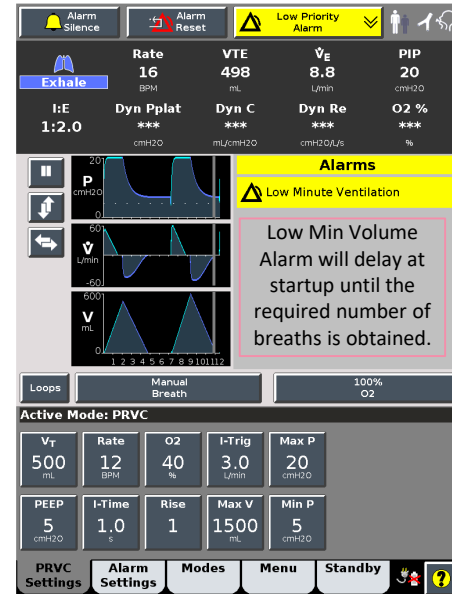

New Software (Version 1.3)

Flow-Trak

Flow-Trak provides additional flow on demand if the set Peak Flow is not high enough to satisfy the patient's inspiratory flow requirements.

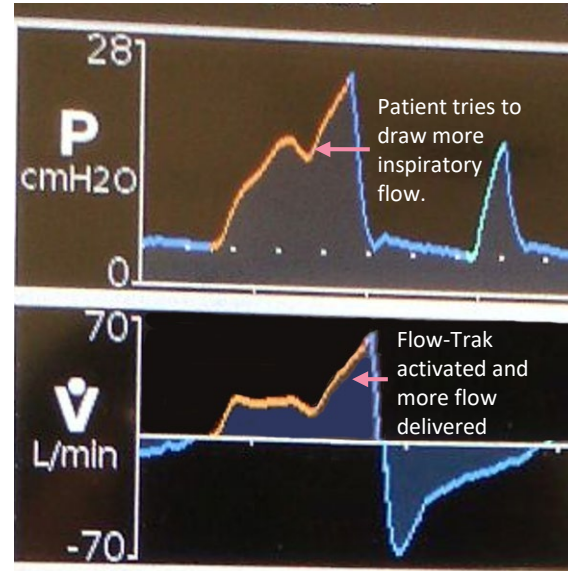
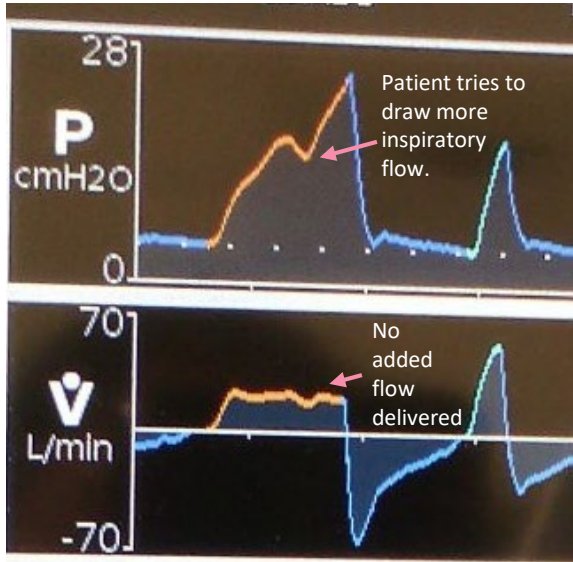

Old Software without Flow-Trak (Version 1.2)

New Software with Flow-Trak (Version 1.3)

Philips Ventilator Open Interface (PVOI)

- V680 Expanded communications protocol
- Available to all monitor and EMR providers for driver creation





Trilogy 202

Simplicity
and
versatility

- Volume-control and pressure-control ventilator
- Invasive and noninvasive ventilation
- The versatile breath delivery and setup options free you from burdensome equipment exchanges
- Compensates for leaks in both pressure and volume control modes



- Intra-hospital transport with a 3 hour internal battery and optional 3 hour external battery
- Patients 5Kg and up
- For use in hospital and alternative care sites
- Uniform settings to support hospital to home transition
- Connectivity Option

Philips Trilogy 202 Ventilator



Standard Features

- Basket with 2 hooks and 2 cord wraps
- Humidifier mount
- Mounting plate for Trilogy
- Rail mounting (both sides)
- Cord tethers (3) at ventilator base level
- Five wheel base (4" casters, 4 locking, 1 non-locking)
- Threaded mounting sockets (2)
- Cable Clearance for Connectivity

Optional Accessories

- Oxygen Tank Holders accommodate 4.25 inch (shown) and 5.5 inch (Not shown) diameter tanks). This accessory includes an oxygen manifold bracket.
- Oxygen Manifold (not visible)
- Water Bag Pole and mounting block (shown)
- Support Arm (shown)
- Rail mounting block (shown)
- CleanClip Bracket (shown)
- Accessory Mounting Post (shown)



Features	V60	V680	TRILOGY 202
Circuit	Single-limb Passive (non-heated, heated)	Single-Limb Passive Dual-Limb – pediatric, adult (Non-heated, heated)	Adult/Pediatric: Single-Limb Passive (invasive, noninvasive) Single-Limb Active (invasive, noninvasive)
Patient type	>20kg	Pediatric 5-20kg Adult >20kg	Pediatric 5-20kg Adult >20kg
Modes	Noninvasive: S/T, AT, PCV, CPAP, AVAPS, PPV*, AT+	Noninvasive: S/T, PCV, CPAP, AVAPS, AT+, PPV*, AVAPS+*, Invasive: A/C-VCV, A/C PCV, SIMV-VCV, PSV, PRVC	Noninvasive: S/T, PCV, CPAP, AVAPS, AT+, Invasive: A/C-VCV, A/C PCV, SIMV-VCV, PSV, CV
Graphics	Pressure, Flow, Volume	Waveforms: Pressure, Flow, Volume Loops: Flow/Volume, Pressure/Volume	Waveforms: Pressure, Flow
Transport	Manifold kit, O2 tank holders	Manifold Kit, O2 Tank Holders	Manifold Kit, O2 Tank Holders
Battery	Up to 6 hours	Up to 4 hours	Up to 6 hours: 3 hour internal, 3 hour detachable (optional)
Weight	11.7kg	12.3kg	5.6kg
Communication	Multiple Options	Multiple Options	Multiple options
Additional Features	100% FiO2 button (software v2.3) Auto-escalating alarms (software v.2.3)	Respiratory Mechanics Expanded Monitoring Options 100% FiO2 button Manual Breath Button Apnea Ventilation Compliance Compensated Vt Aerogen USB Controller Circuit Occlusion Ventilation Inspired O2 Monitoring Auto-escalating alarms	Auto-adaptive triggering, cycling, and leak compensation (available in all modes, passive circuit only) SD Card Port 100% FiO2 button Oximetry Mouth Piece Ventilation AVAPS AE

Connectivity

IntelliBridge EC10/EC5 Module

Module with Drivers

Connection Cable

ID Module/Key to specific external device



RS-232 port

Remote alarm port

IntelliBridge EC10 Connectivity to V60 and V680

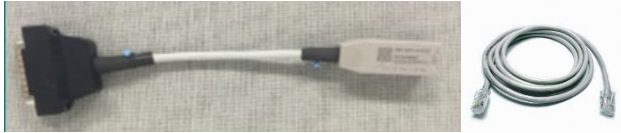

EC5 with 25pin plug and CAT 5 cable
865114 #105 #L01

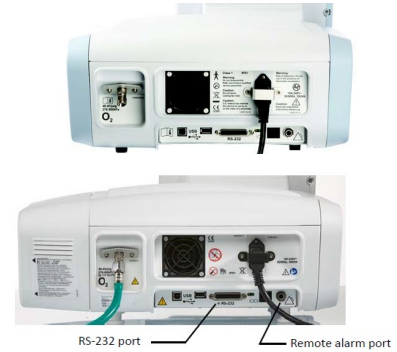

IntelliBridge Module EC10
865115 A01 #101
MX500-MX800



IntelliBridge Interface Board #J32
MX400-MX 550 #J32

IntelliVue PM SW H.15 and higher

Connectivity to Trilogy 202

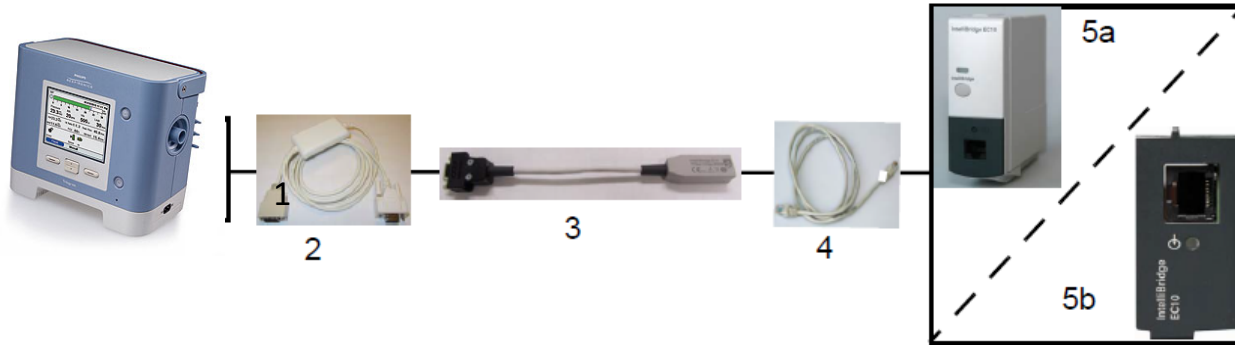

IntelliVue PM SW H.15 and higher

1 Philips Respironics Trilogy ventilator **SW Rev 14.x and higher**

2 Trilogy isolated RS232 9 pin serial cable (PN: 1046972)

3 IntelliBridge EC5 ID dongle 865114 ED#237#Lxx (labeled: "Philips Trilogy 202/O2")

4 CAT5 cable 1,5/3/10 m = #L 01,02,03

5a IntelliBridge Module EC10 865115/A01 #237 **ED237** (MX500-MX800)

5b IntelliBridge Interface Board EC10* MX400-MX550 #J32

IntelliBride EC40/80 connection to Trilogy

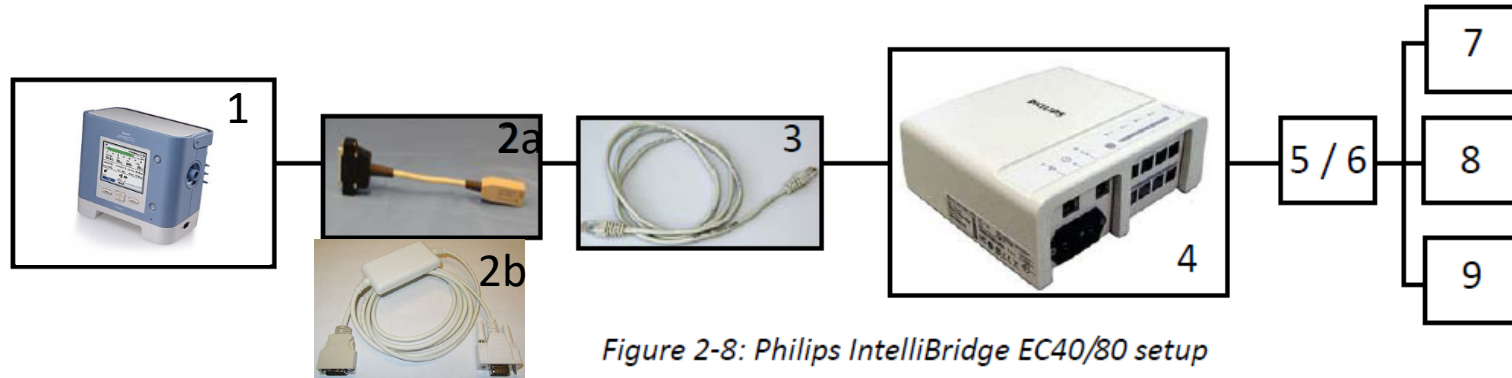

1 Philips Respironics Trilogy ventilator SW Rev 14.x and higher
2a Trilogy isolated RS232 9 pin serial cable (PN: 1046972)

2b IntelliBride EC5 ID dongle 865114 IB ED237(labeled: "Philips Trilogy 202/O2") PN 865056-10017
3 CAT5 cable 1,5/3/10 m = #L 01,02,03
4 IntelliBride EC40/80 865056/ with device driver IB **ED237**

HRC Consumables

Ventilators

Noninvasive

Invasive



Respironics V60



DreamStation

Mid Acuity



Low Acuity



Respironics V680



Trility 202

Consumables

Noninvasive Ventilation Masks and Circuits

AF541



PerforMax

AF531



AF421

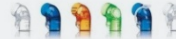

AF811



AP111

Pediatric PerforMax



PN841

Total NIV Solution

The total noninvasive solution combines the market leading technologies in our ventilators with the market leading technologies in our interfaces.

Our NIV masks are designed to work seamlessly with our NIV ventilators to provide optimal ventilation and patient compliance.

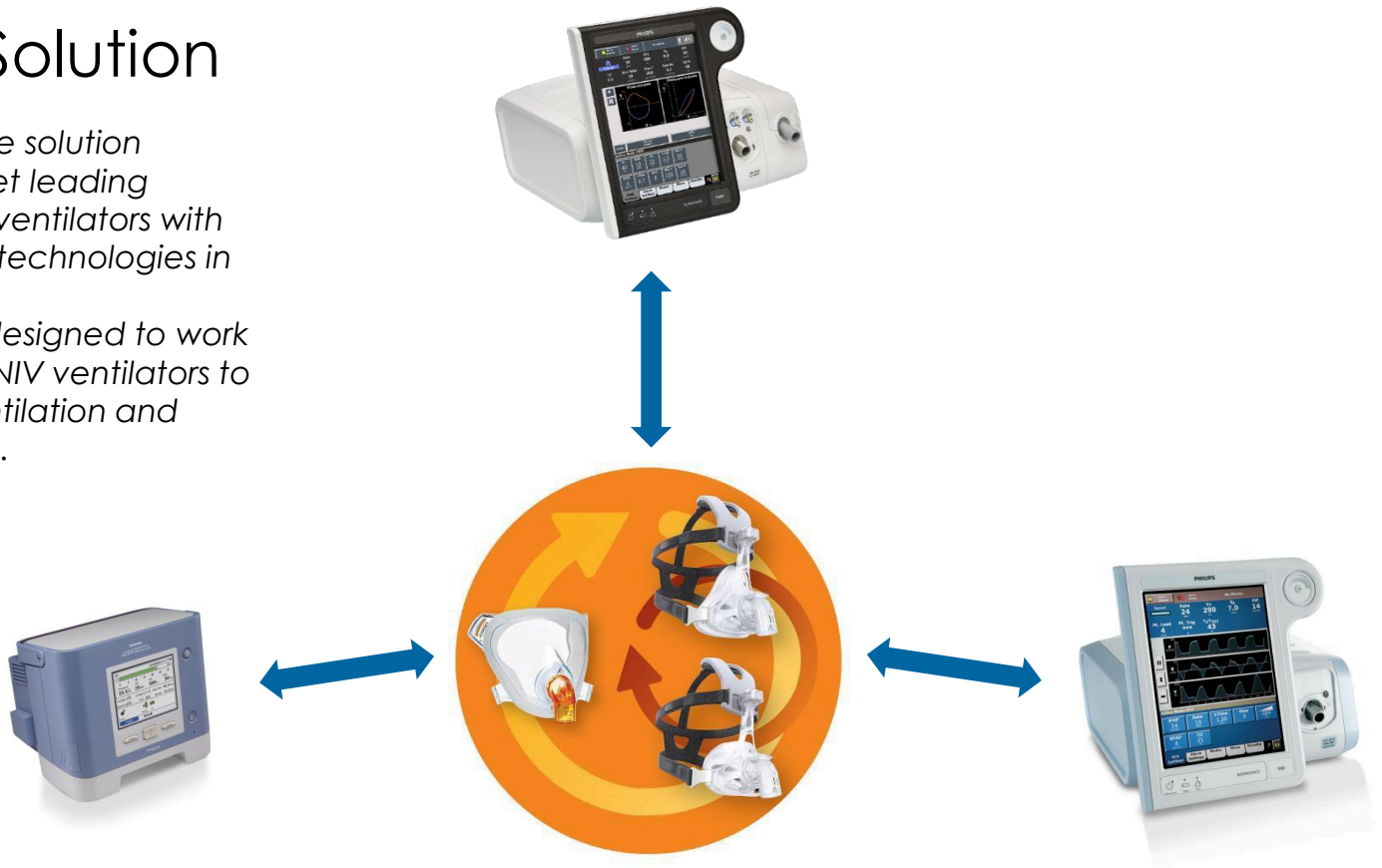

Philips HRC Consumable Products

Noninvasive Ventilation Masks and Circuits

ADULT

AF541



AF531



AF421



PerforMax



AF811



AP111

Pediatric



PN841



Pediatric PerforMax

Circuits

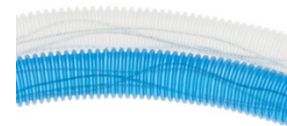

PHILIPS

AF541 – Best Solution

- Delivering high-quality respiratory care to your patients in today's complex healthcare environment demands new thinking — especially when it comes to patient comfort and addressing skin breakdown.
- Designed to rest comfortably on the face, the Philips AF541 noninvasive ventilation (NIV) mask features interchangeable under-the-nose (UTN) and over-the-nose (OTN) cushions to achieve the benefits of mask rotation while using a single mask.
- Made from materials that do not contain BPA

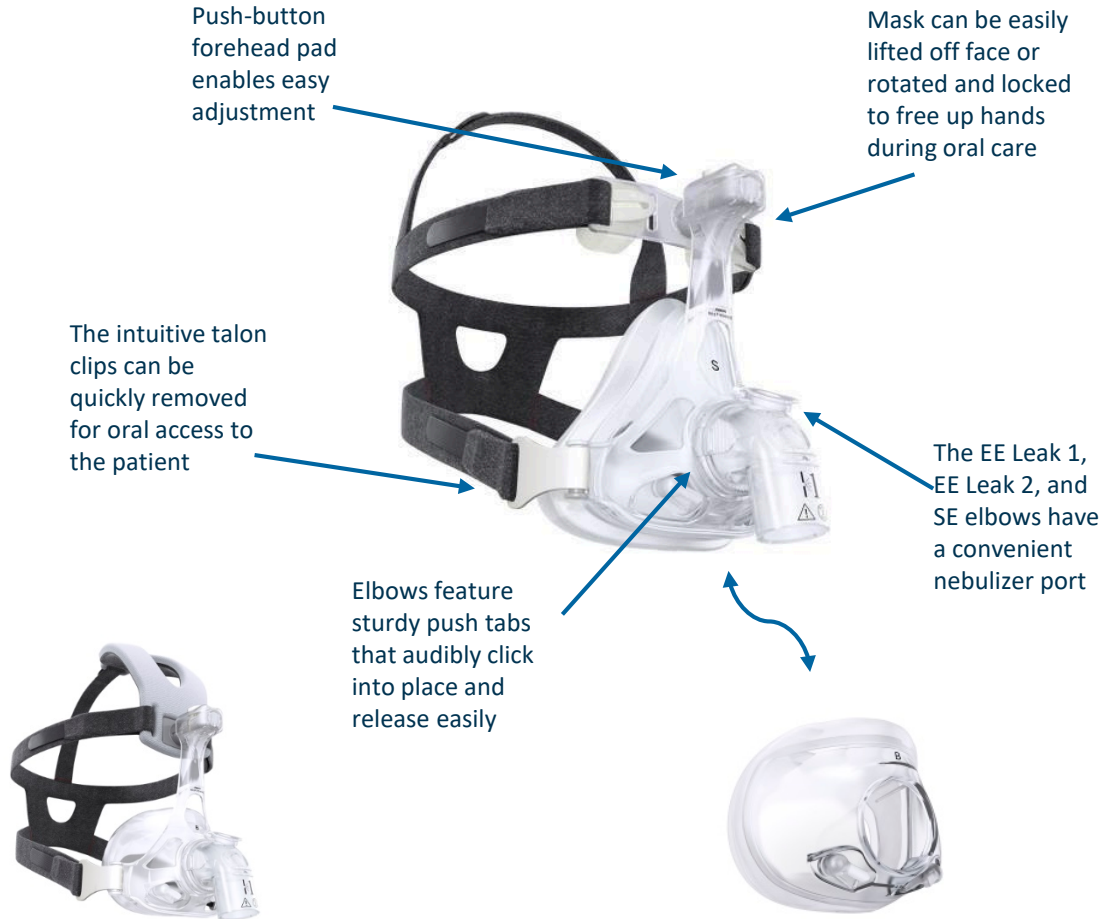

AF541 Interchangeable Elbows



EE Leak 1 NIVO Port



SE Leak 1 NIVO Port



EE Leak 2 NIVO Port

Interchangeable Elbows Improve workflow

- NIVO port in all elbows
- Easy to change
- Audible click confirms elbow is secure

AF421 – Good Solution

- Innovative bellows style cushion to aid comfort and leak prevention
- Simple, intuitive Talon Clips
- New sizing gauge technique
- Pediatric through XL sizes (S,M,L, XL)
- Green packaging with zip-lock bag
- 20 pack bulk packaging (Leak 1 only)
- Replacement for Image 3
- Clean Clip holder included





Good	Best
AF421	AF541
Single leaf, bellows cushion	Dual-leaf, premium cushion
No adjustment on forehead pad	Adjustable forehead pad
Translucent, two-piece shell	One-piece, crystal clear shell
Elbows fixed	Interchangeable elbows
EE, SE, and Leak 2	EE, SE and Leak 2 Bronch* and NIVO elbows
Hinged forehead piece	Available CapStrap feature
Clean Clip mask storage / Clean Clip Sidecar	Clean Clip mask storage
Automatic leak calibration	Automatic leak calibration



PerforMax

Key advantages

- Improves comfort, minimizes skin breakdown, and eliminates nasal bridge challenges
- Standard adult size fits most patients.
- Perimeter facial contact maximizes comfort and simplifies fitting by sealing around the flat surfaces of the face and avoiding the sensitive nasal bridge.
- The clear, unobstructed view provided by the PerforMax Full Face Mask helps reduce patient claustrophobia.
- Interchangeable elbows accommodate quick transitions between single- and dual-limb ventilator circuits. With a choice of the standard elbow (SE) for dual-limb systems and the entrainment elbow (EE) for single-limb systems, clinicians can use the PerforMax Mask with any noninvasive ventilator.



PN841 Pediatric Nasal Mask



- ✓ Develop a mask truly designed for children
- ✓ Provide support to clinicians (and parents) and ease the stresses of a child's treatment
- ✓ Build on the success of other Philips Respironics pediatric masks!
- ✓ This mask has a Leak 3 and SE elbow option
- ✓ May be used on patients that weigh 5kgs or greater
 - There is no age requirement
 - There is no set upper limit.
- ✓ Mask free from natural rubber latex, DEHP or BPA
- ✓ 3 Mask package options
 - Small, Medium, Large

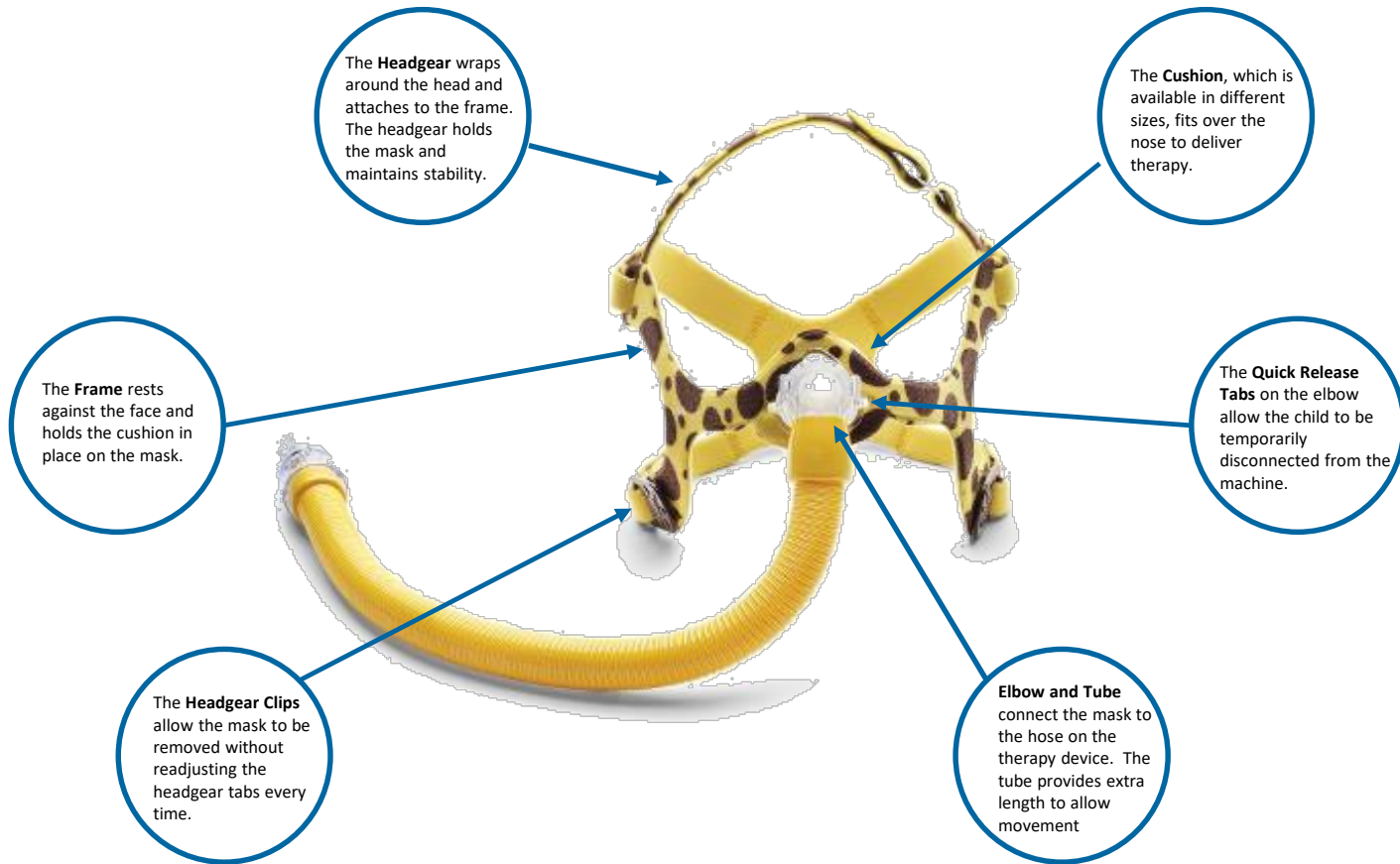

Pediatric PerformMax



Internal use only

Key advantages

- ✓ PerformMax allows for quick fitting and elimination of nasal bridge challenges For patients 1 year or older and >7kg
- ✓ Pink, blue, and yellow bonnet selection Cushion provides a sealing surface around the perimeter of face
- ✓ Compatible with single limb and dual-limb noninvasive ventilators
- ✓ CleanClip supports infection control effort
- ✓ Along with Sami and Tucker on the packaging, the XSmall and XXSmall size have other child-friendly design features that address the comfort and compliance needs of your patients



PHILIPS

